

#42

FOAM GAP VALLEY CONNECTION

CUT/INSTALL ROOF PANELS SUCH THAT THERE IS A $\frac{1}{2}$ " GAP WHICH IS TO BE FILLED W/ A CONT. BEAD OF EXPANDING FOAM SEALANT.

ATTACH PANELS TO BLOCKING ON DBL. LVL VALLEY BEAM W/ SIP FASTENERS @ 10" O.C. TYPICAL UNLESS OTHERWISE NOTED.

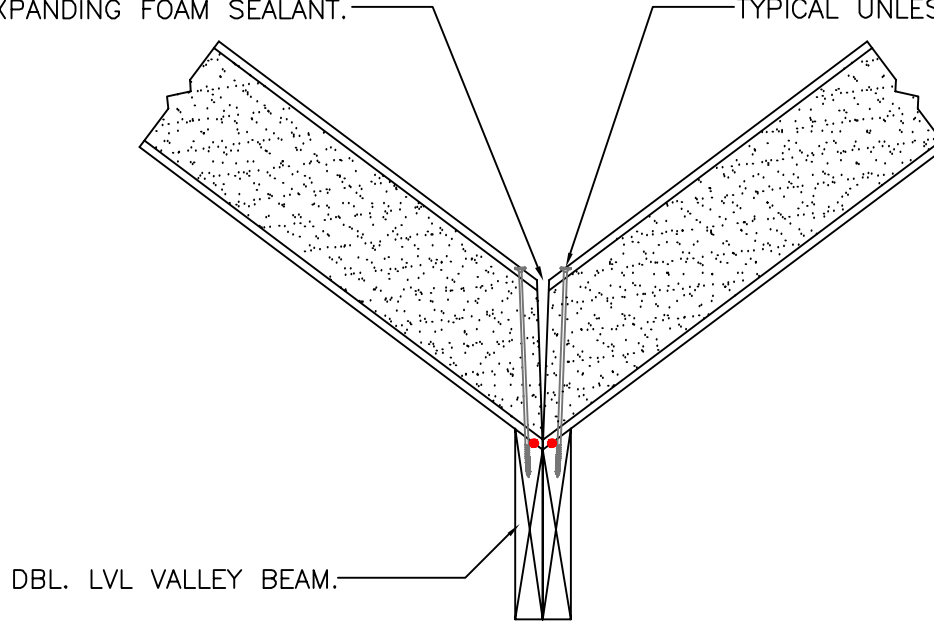

NOTE: ALL RED DOTS - APPLY CONTINUOUS $\frac{3}{8}$ " DIA. BEAD OF MASTIC SEALANT BETWEEN 2x MEMBER & PANEL FOAM.

PANEL VALLEY CONNECTION DETAIL
SCALE: 1" = 1'-0"

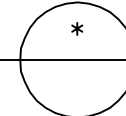

Foard
P A N E L
i n c o r p o r a t e d
P.O. Box 185, West Chesterfield, NH 0346
(603) 256-8800