

#4

# PLUMB CUT EAVE CONNECTION

ATTACH PANELS TO TIMBER FRAME MEMBERS W/ SIP FASTENERS @ 10" O.C. (5 PER 4' PANEL WIDTH) W/ A MIN. OF 2" OF EMBEDMENT INTO ALL TIMBERS. TYPICAL UNLESS OTHERWISE NOTED.

STUFF EXPOSED PANEL EDGE W/ CONT. BEVELED 2x MATERIAL. SECURE OSB PANEL SKINS TO 2x W/ 0.131" DIA. x 2 1/2" LONG GALV. NAILS @ 6" O.C. OR EQU.

CUT/INSTALL WALL PANELS SUCH THAT THERE IS A 1/2" GAP WHICH IS TO BE FILLED W/ A CONT. BEAD OF EXPANDING FOAM SEALANT.

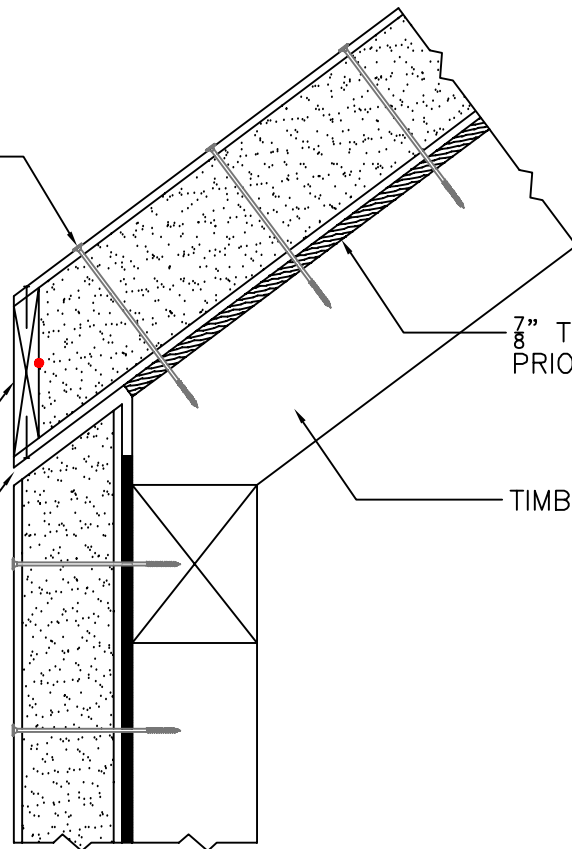

7/8" T&G DECKING APPLIED PRIOR TO PANEL INSTALLATION.

TIMBER FRAME MEMBER.

NOTE: ALL RED DOTS - APPLY CONTINUOUS 3/8" DIA. BEAD OF MASTIC SEALANT BETWEEN 2x MEMBER & PANEL FOAM.

PANEL EAVE CONNECTION DETAIL  
SCALE: 1" = 1'-0"

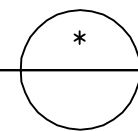

**Foard**  
P A N E L  
i n c o r p o r a t e d  
P.O. Box 185, West Chesterfield, NH 0346  
(603) 256-8800