

#32

# PLUMB CUT EAVE CONNECTION

ATTACH PANEL TO 2x BLOCKING IN WALL  
PANEL W/ SIP FASTENERS @ 10" O.C.  
TYPICAL UNLESS OTHERWISE NOTED.

STUFF EXPOSED PANEL EDGE  
W/ BEVELED 2x MATERIAL. SECURE  
OSB PANEL SKINS TO 2x BLOCKING  
W/ 0.131" DIA. x 2½" LONG  
GALV. NAILS @ 6" O.C. OR EQU.

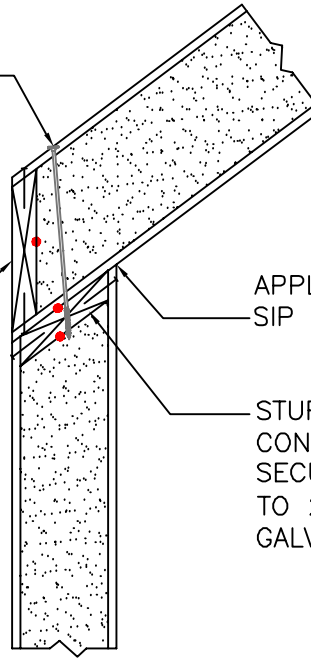

APPLY CORVUM 30/30  
SIP TAPE @ INT. CORNER

STUFF EXPOSED PANEL EDGE W/  
CONT. BEVELED 2x BLOCKING MATERIAL.  
SECURE OSB PANEL SKINS  
TO 2x W/ 0.131" DIA. x 2½"  
GALV. NAILS @ 6" O.C. OR EQU.

NOTE: ALL RED DOTS - APPLY CONTINUOUS  
¾" DIA. BEAD OF MASTIC SEALANT  
BETWEEN 2x MEMBER & PANEL FOAM.

PANEL EAVE CONNECTION DETAIL

SCALE: 1" = 1'-0"

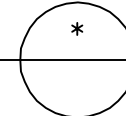

**Foard**  
P A N E L  
i n c o r p o r a t e d  
P.O. Box 185, West Chesterfield, NH 0346  
(603) 256-8800