

#10

PANEL TO 1st FLOOR DECK CONNECTION

ATTACH PANELS TO TIMBER FRAME MEMBERS W/ SIP FASTENERS @ 10" O.C. (5 PER 4' PANEL WIDTH) W/ A MIN. OF 2" OF EMBEDMENT INTO ALL TIMBERS. TYPICAL UNLESS OTHERWISE NOTED.

ATTACH CLEAT PRIOR TO INSTALLING PANEL INTO PLACE. ATTACH 2x CLEAT PLATE TO SUBFLOOR W/ 2 ROWS OF 0.131" DIA. x 3/4" LONG GALV. NAILS @ 6" O.C. OR EQU.

SECURE OSB PANEL SKINS TO 2x CLEAT W/ 0.131" DIA. x 2 1/2" LONG GALV. NAILS @ 6" O.C. OR EQU.

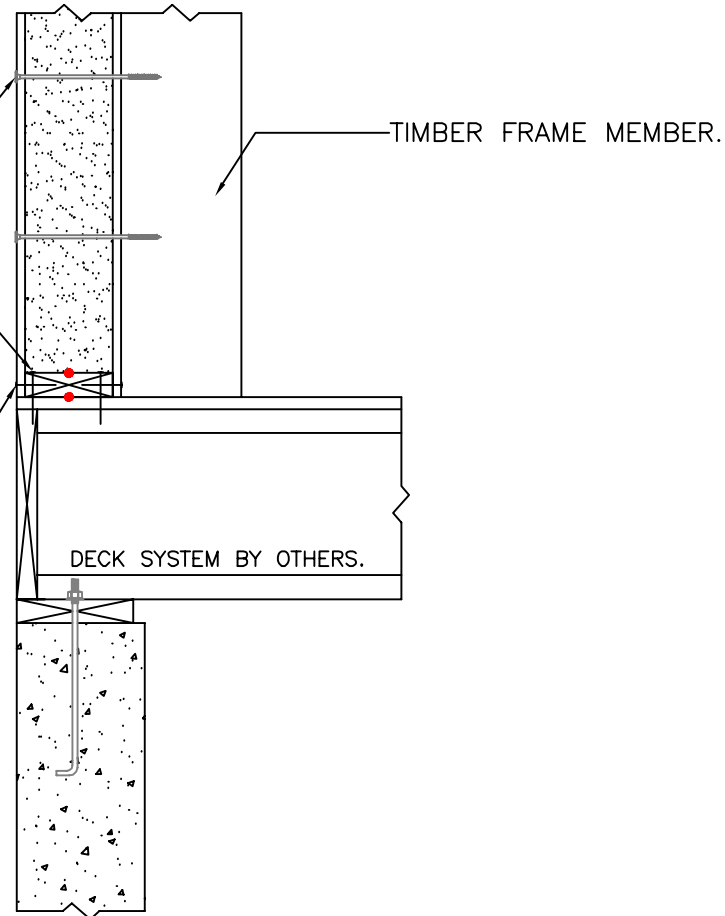

NOTE: ALL RED DOTS - APPLY CONTINUOUS 3/8" DIA. BEAD OF MASTIC SEALANT BETWEEN 2x MEMBER & PANEL FOAM.

PANEL TYPE: STRUCTURAL PANEL APPLIED DIRECTLY TO THE FRAME

PANEL SILL CONNECTION DETAIL
SCALE: 1" = 1'-0"

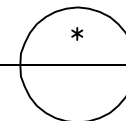

Foard
P A N E L
i n c o r p o r a t e d
P.O. Box 185, West Chesterfield, NH 0346
(603) 256-8800