

#58

# PANEL SILL CONNECTION W/ HOLD-DOWN

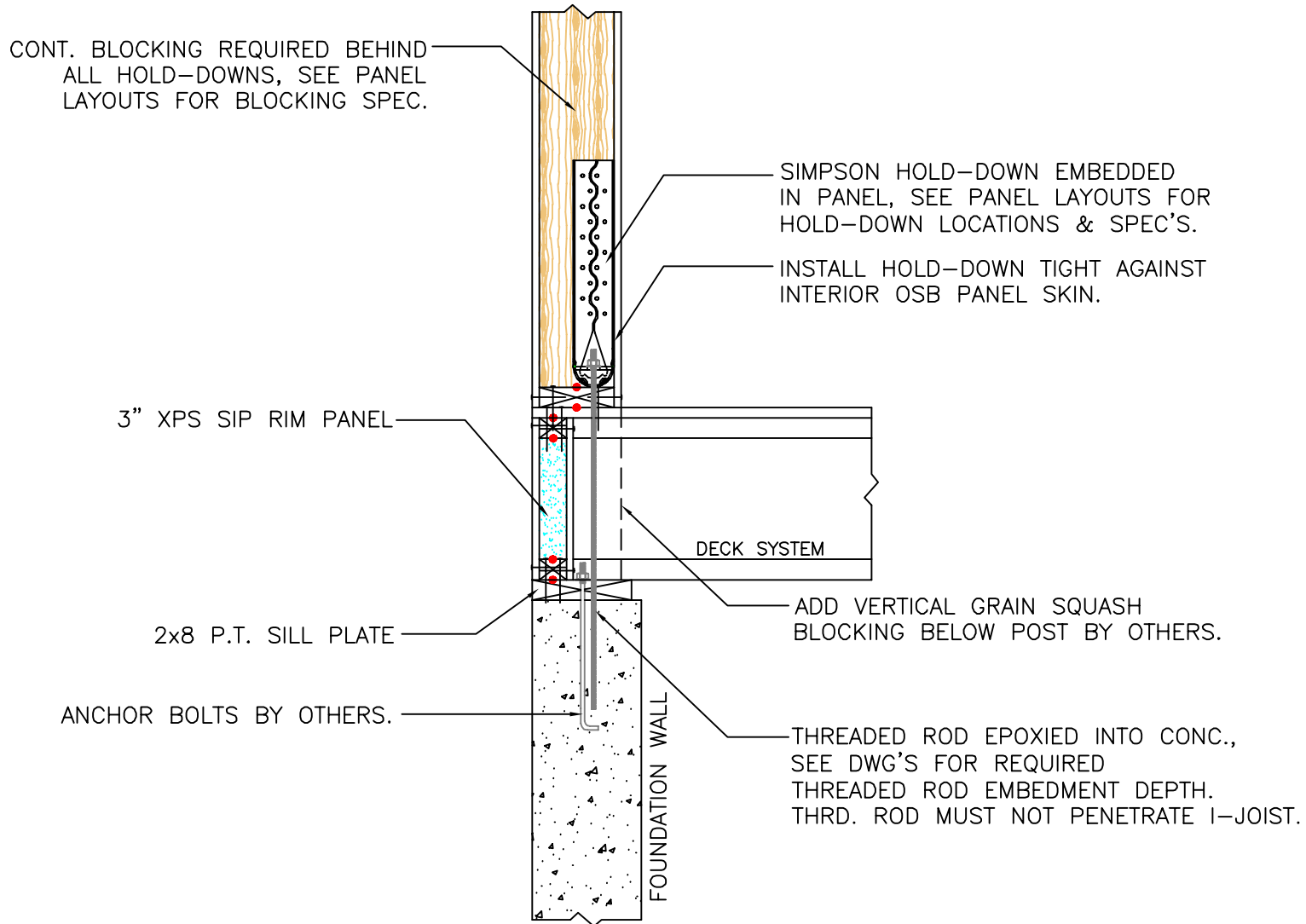

NOTE: ALL RED DOTS - APPLY CONTINUOUS  $\frac{3}{8}$ " DIA. BEAD OF MASTIC SEALANT BETWEEN 2x MEMBER & PANEL FOAM.

PANEL SILL CONNECTION W/ HOLD-DOWN  
SCALE: 1" = 1'-0"

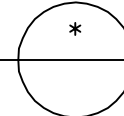

**Foard**  
P A N E L  
i n c o r p o r a t e d  
P.O. Box 185, West Chesterfield, NH 0346  
(603) 256-8800