

#36

ROOF PANEL RAKE OVERHANG CONNECTION

ATTACH PANEL TO 2x BLOCKING IN WALL
PANEL W/ SIP FASTENERS @ 10" O.C.
TYPICAL UNLESS OTHERWISE NOTED.

STUFF EXPOSED PANEL EDGE
W/ CONT. 2x MATERIAL. SECURE
OSB PANEL SKINS TO 2x BLOCKING
W/ 0.131" DIA. x 2½" LONG
GALV. NAILS @ 6" O.C. OR EQU.

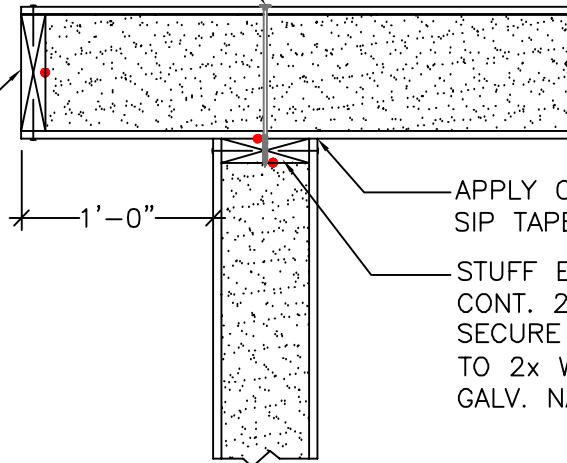

APPLY CORVUM 30/30
SIP TAPE @ INT. CORNER

STUFF EXPOSED PANEL EDGE W/
CONT. 2x BLOCKING MATERIAL.
SECURE OSB PANEL SKINS
TO 2x W/ 0.131" DIA. x 2½"
GALV. NAILS @ 6" O.C. OR EQU.

NOTE: ALL RED DOTS - APPLY CONTINUOUS
¾" DIA. BEAD OF MASTIC SEALANT
BETWEEN 2x MEMBER & PANEL FOAM.

PANEL RAKE CONNECTION DETAIL
SCALE: 1" = 1'-0"

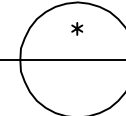

Foard
P A N E L
i n c o r p o r a t e d
P.O. Box 185, West Chesterfield, NH 0346
(603) 256-8800