

ATTACH PANEL TO ADJACENT PANEL  
W/ SIP FASTENERS @ 10" O.C.  
OR 5 PER 4' PANEL WIDTH.  
TYPICAL UNLESS OTHERWISE NOTED.

STUFF EXPOSED PANEL EDGE W/ CONT.  
2x MATERIAL. SECURE OSB PANEL  
SKINS TO 2x W/ 0.131" DIA. x 2½"  
GALV. NAILS @ 6" O.C. OR EQU.

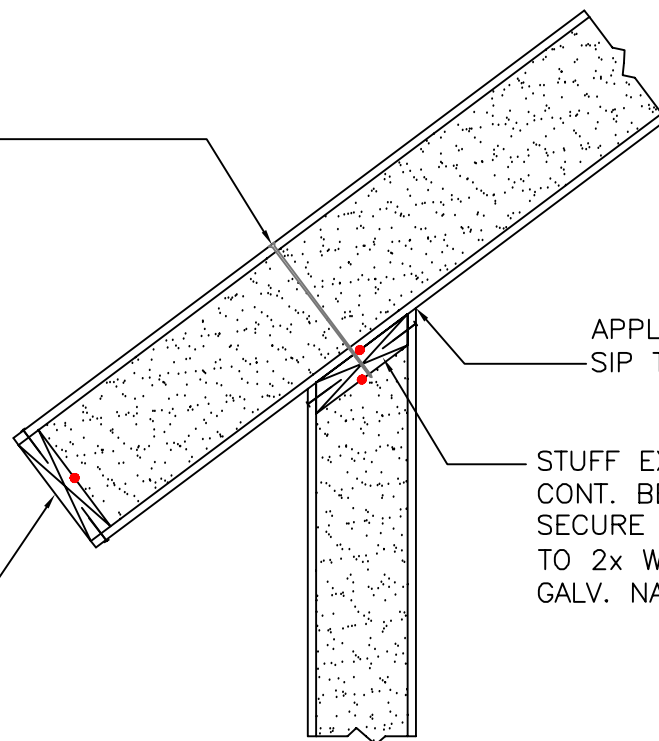

APPLY CORVUM 30/30  
SIP TAPE @ INT. CORNER

STUFF EXPOSED PANEL EDGE W/  
CONT. BEVELED 2x BLOCKING MATERIAL.  
SECURE OSB PANEL SKINS  
TO 2x W/ 0.131" DIA. x 2½"  
GALV. NAILS @ 6" O.C. OR EQU.

NOTE: ALL RED DOTS – APPLY CONTINUOUS  
¾" DIA. BEAD OF MASTIC SEALANT  
BETWEEN 2x MEMBER & PANEL FOAM.

SQUARE CUT PANEL EAVE CONNECTION DETAIL

SCALE: 1" = 1'-0"

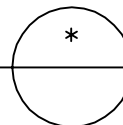

*Foard*

P A N E L

incorporated

P.O. Box 185, West Chesterfield, NH 03466  
(603) 256-8800