

SIMPSON HOLD-DOWN EMBEDDED
IN PANEL, SEE PANEL LAYOUTS FOR
HOLD-DOWN LOCATIONS & SPEC'S.

ATTACH PANEL TO ADJACENT PANEL
W/ SIP FASTENERS @ 10" O.C.
OR 5 PER 4' PANEL WIDTH.
TYPICAL UNLESS OTHERWISE NOTED.

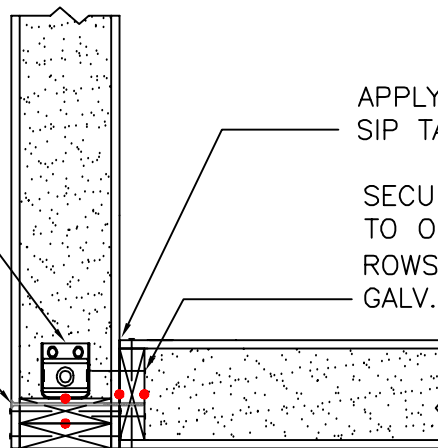

APPLY CORVUM 30/30
SIP TAPE @ INT. CORNER

SECURE CONT. 2x EMBEDDED IN SIP
TO OSB PANEL SKIN W/ 2 STAGGERED
ROWS OF 0.131" DIA. x 3/4" LONG
GALV. NAILS @ 8" O.C. OR EQU.

SECURE OSB PANEL SKINS TO 2x BLOCKING
W/ 0.131" DIA. x 2 1/2" GALV. NAILS @ 6"
O.C. OR EQU. EACH SIDE, EACH FACE.

NOTE: ALL RED DOTS - APPLY CONTINUOUS
3/8" DIA. BEAD OF MASTIC SEALANT
BETWEEN 2x MEMBER & PANEL FOAM.

CORNER CONNECTION DETAIL W/ HOLD DOWN
SCALE: 1" = 1'-0"

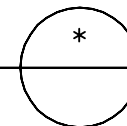

Foard
P A N E L
i n c o r p o r a t e d
P.O. Box 185 , West Chesterfield, NH 03466
(603) 256-8800