

#13

PANEL TO 1st FLOOR DECK CONNECTION

ATTACH PANELS TO TIMBER FRAME MEMBERS W/ SIP FASTENERS @ 10" O.C. (5 PER 4' PANEL WIDTH) W/ A MIN. OF 2" OF EMBEDMENT INTO ALL TIMBERS. TYPICAL UNLESS OTHERWISE NOTED.

ATTACH PANEL TO DECK SYSTEM W/ 2 ROWS OF SIP FASTENERS @ 10" O.C. OR 5 PER 4' PANEL WIDTH. TYPICAL UNLESS OTHERWISE NOTED.

INSTALL 2x INTO PANEL PRIOR TO CRANING PANEL INTO PLACE. SECURE OSB PANEL SKINS TO EMBEDDED 2x W/ 0.131" DIA. x 2 1/2" LONG GALV. NAILS @ 6" O.C. OR EQU.

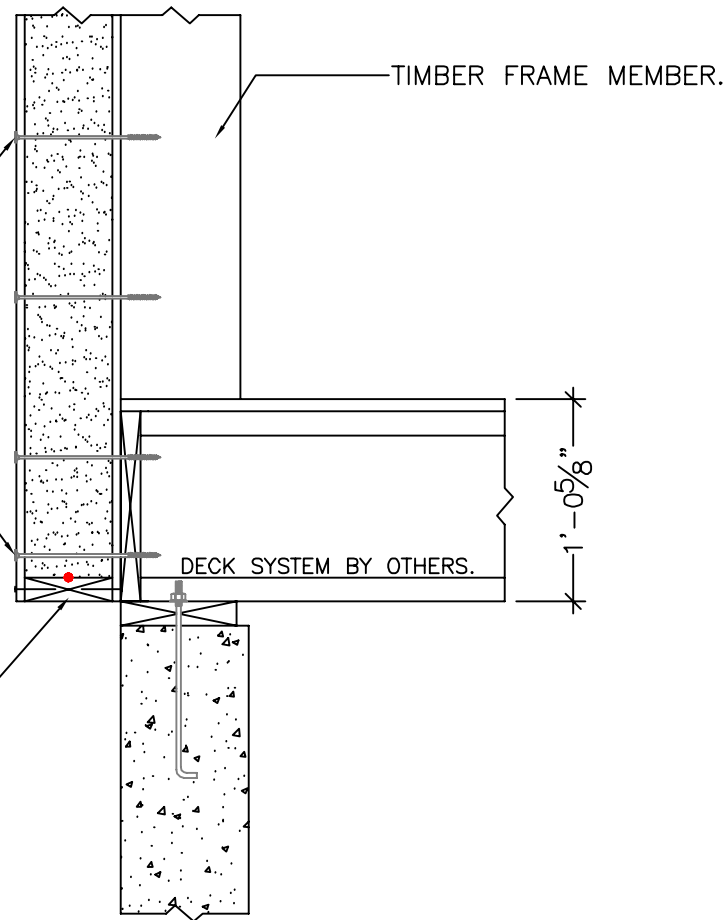

NOTE: ALL RED DOTS - APPLY CONTINUOUS 3/8" DIA. BEAD OF MASTIC SEALANT BETWEEN 2x MEMBER & PANEL FOAM.

[PANEL TYPE: STRUCTURAL PANEL APPLIED DIRECTLY TO THE FRAME]

PANEL SILL CONNECTION DETAIL
SCALE: 1" = 1'-0"

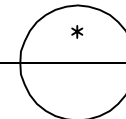

Foard
P A N E L
 incorporated
 P.O. Box 185, West Chesterfield, NH 0346
 (603) 256-8800