

## Skylights & Roof Rot

By Paul Malko, Mechanical Engineer

Flashing leaks at the skylight are very common in SIP and stick & infill construction.

This can be caused by improper installation and flashing, but many times the directions are followed properly and leaks still occur. The flashing technique used for SIP roofs is exactly the same as a stick built roof, the difference is in the stress applied to the flashing. Figure 1 shows a simplified skylight installation in a SIP roof.

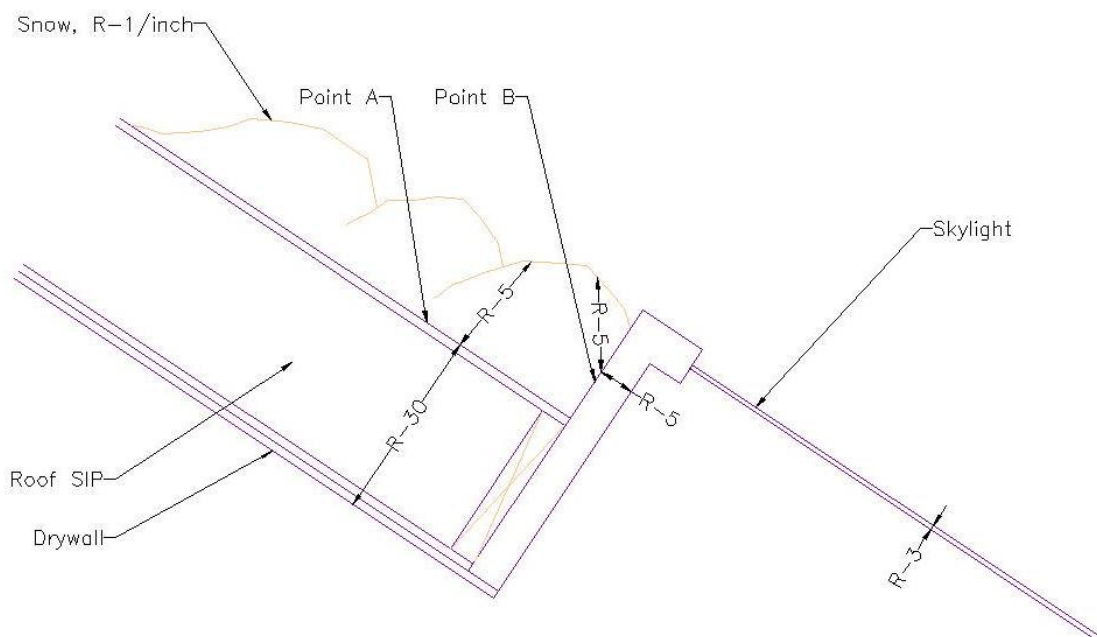

Figure 1: Vertical section through roof and curbed skylight

The figure shows a common “curbed” skylight. This curbing creates an un-pitched, or flat, valley above the skylight. It is this valley that causes most of the problems, water and snow does not readily to flow out of the valley.

Freeze thaw cycles, due to heat loss through the skylight curb assembly and the lack of heat loss through the adjacent roof. Adding crickets above skylights will reduce potential water infiltration and resulting rot.